

# Connecting an Android Phone or Tablet

1. Open the Wi-Fi settings on your phone or tablet.

*Different Android devices have different ways to get to these settings. Check the website for your phone if you need to find how to open the settings.*

Tap "SDUHSD" to sign in.

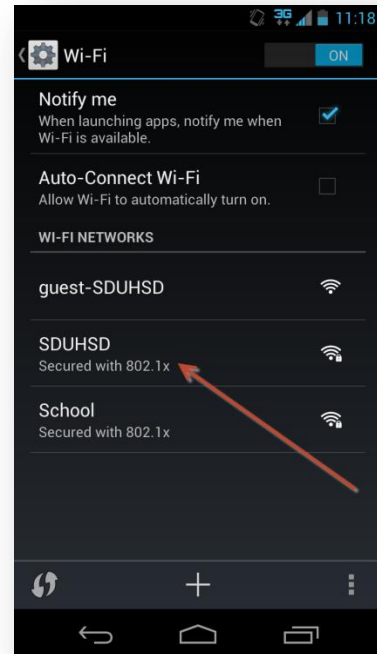

2. Under "Identity", enter your district username:

*Staff:* **firstname.lastname**

*Students:*

**last name + first initial + last 4 digits of permanent ID**

Leave "Anonymous identity" blank.

Under "Password", enter the password you use to login to district computers.

Tap "Save" to connect.

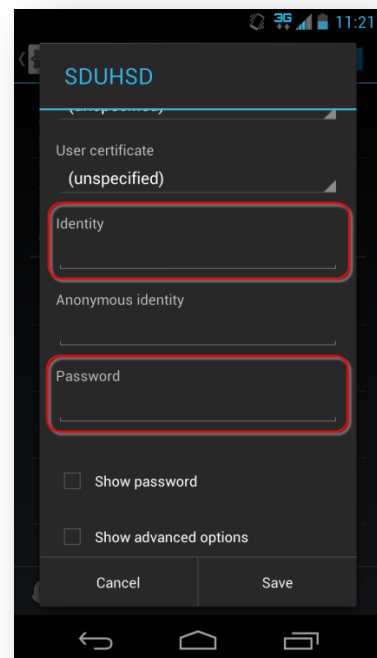

3. After a few seconds, you will see "Connected" show up underneath the SDUHSD network. In the future, your device will connect to the network automatically.

*If your device cannot connect to SDUHSD, try the same steps to connect to "guest-SDUHSD". If you can only connect to the guest network, you will have to enter your name and password each time you log in.*